

PRODUCT SHEET



| TANK | |
|--------|---------|
| LENGTH | 1450 MM |
| WIDTH | 1255 MM |
| HEIGHT | 715 MM |

PRODUCT CODE:
PTCTDI800

800L DIESEL TRANSPORT TANK

FEATURES

- Cast diesel lid with lockable inlet mesh filter, 4m earth strap and breather
- Heavy duty construction (built to last)
- Manufactured from UV stabilised virgin grade materials (not recycled)
- Secure mounting points in each leg
- 2 year warranty
- Tanks manufactured from Diesel grade material to AS 2809.2.2008
- Outlet fittings available in sizes 1", 1½" or 2"

COLOURS AVAILABLE

Grey

NB: Colours may vary due to screen and printer calibrations.

FREE INCLUSIONS

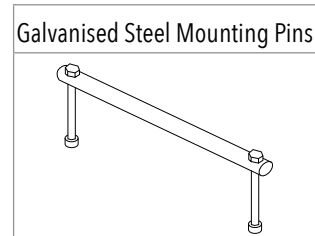
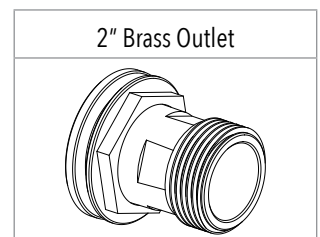
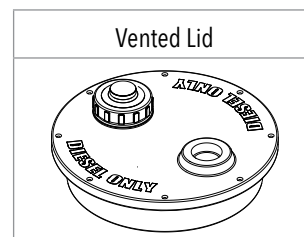

*Inclusions may change without notice, check with sales prior to ordering.

OPTIONAL EXTRAS

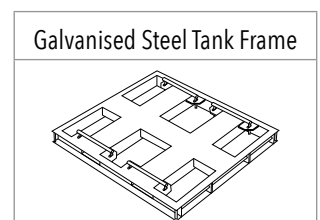
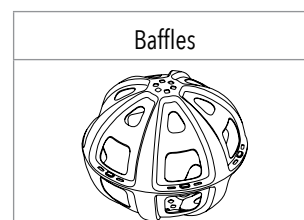

*Various outlet types and sizes also available, please contact sales for a free quote.

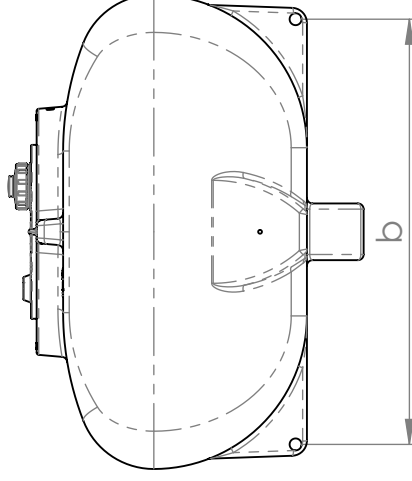
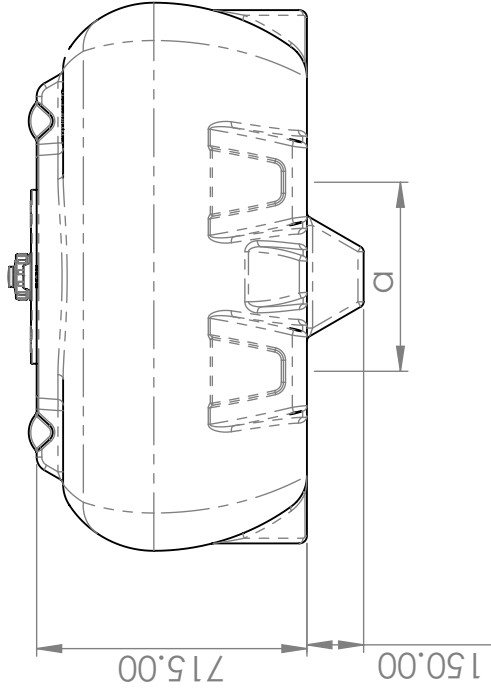
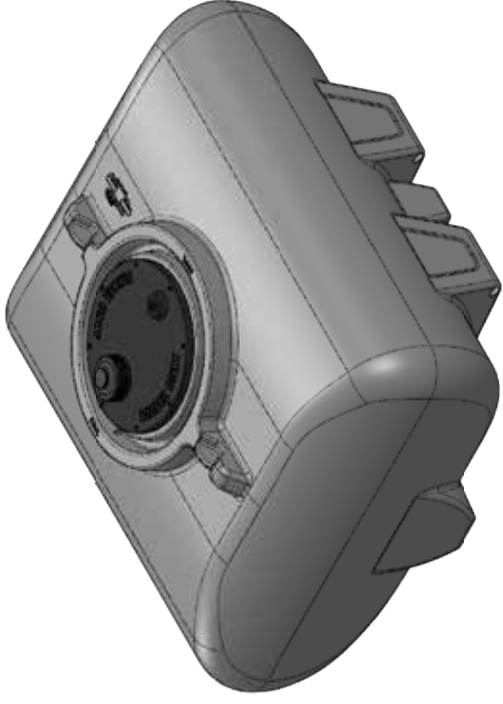
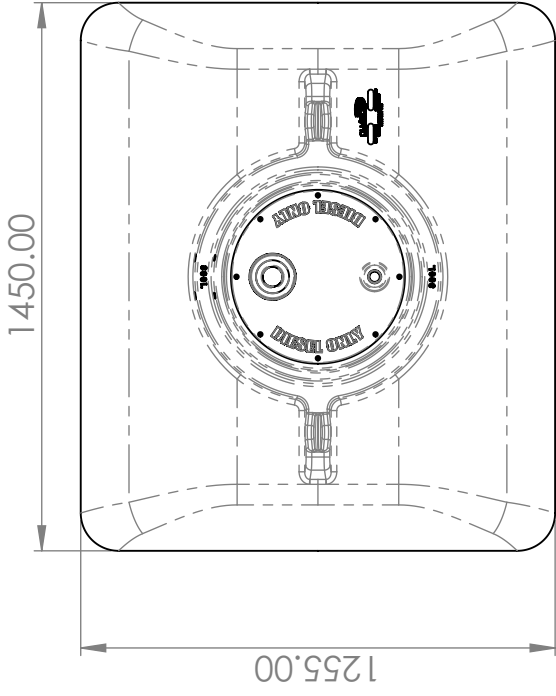

| | |
|---------------|--------------------|
| Leg Pitch (a) | Foot Pin Pitch (b) |
| 500 mm | 1125 mm |



PRODUCT CODE:

PTCTDI800

DESCRIPTION:

800 LITRE DIESEL CARTAGE TANK