

PRODUCT SHEET



Tank as seen in Mountain Blue

LENGTH	2520 MM
WIDTH	810 MM
HEIGHT	2130 MM

PRODUCT CODE:
PTSLWA3000

3,000L SLIMLINE WATER TANK

FEATURES

- Sleek and sophisticated design
- Heavy duty construction
- Manufactured from proven UV stabilised Australian standard material (tested in the field for over 25 years)
- Moulded lifting handles (easy to move)
- Moulded lifting lugs at top (extra strength)

STANDARD INCLUSIONS

- One standard inlet at top & one standard overflow (both at same end)
- 1" raised bucket height outlets at each end
- 1" outlets at each end

FREE INCLUSIONS

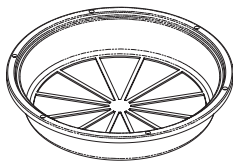
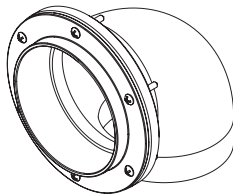
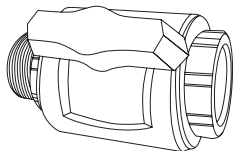
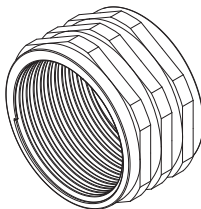
400mm Strainer & Light Guard	90mm Overflow
	
1" Nipple Ball Valve	Moulded in 1" Brass Outlets
	

*Inclusions may change without notice, check with sales prior to ordering

COLOURS AVAILABLE

CB Surf Mist	Birch Grey (CB Dune)	CB Shale Grey	Armour Grey (CB Windspray)	CB Wallaby	CB Basalt	Slate Grey (CB Woodland Grey)
CB Monument	Black (CB Night Sky)	Mountain Blue (CB Deep Ocean)	Metal Grey (CB Ironstone)	CB Cove	Evening Haze	Merino Beige (CB Paperbark)
Gully	CB Jasper	Smooth Cream (CB Classic Cream)	Desert Haze (CB Sandbank)	Wheat	Earthtone (CB Bushland)	CB Mangrove
Mist Green (CB Pale Eucalypt)	Rivergum (CB Wilderness)	Heritage Green (CB Cottage Green)	Heritage Red (CB Manor Red)	<small>NB: COLORBOND® and colour names are registered trademarks of BlueScope Steel Limited*. Colour names, shown in brackets, are trademarks of BlueScope Steel Limited). Colours may vary due to screen and printer calibrations.</small>		

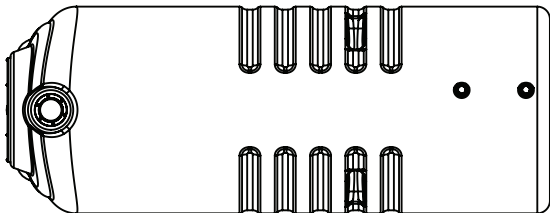
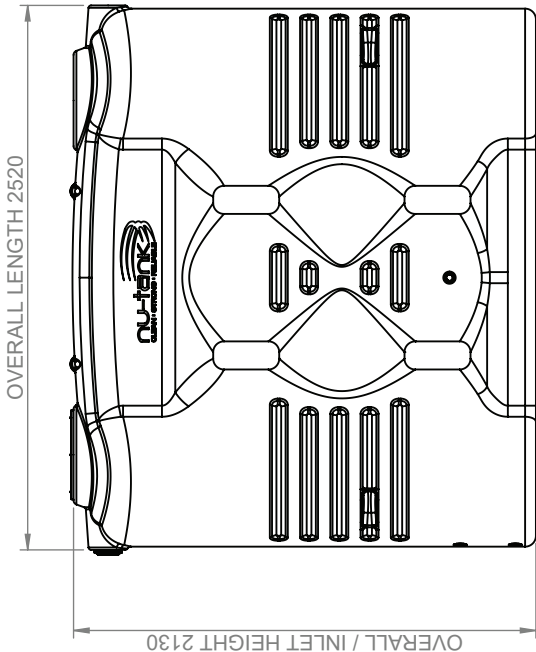
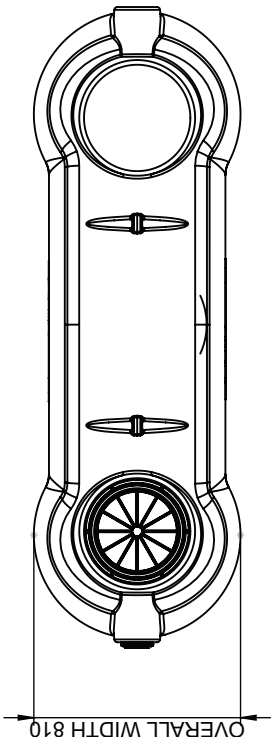
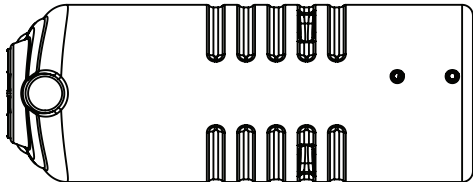
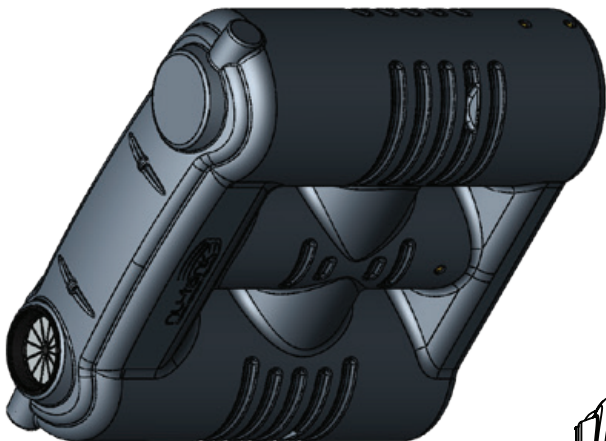

Details

Manufacturer's Name	Nu-Tank Pty Ltd		
Tank Capacity	3000 Litres		
Maximum Specific Gravity	1.0		
Maximum Design Service Temperature	23°C		
Standard	AS/NZS 4766		



PRODUCT CODE:

PTSLWA3000

DESCRIPTION:

3,000L SLIMLINE WATER TANK